

Technical Data

Insulator:Black glass filled polyester PPS or PBT

Flammability:UL 94V-0

Sleeve:Brass

Contact clip(4 finger):Beryllium copper

Mating pin:ø0.40 to ø0.56mm

Forces:(polished steel gauge ø0.43)

Mechanical life:min 500 cycles

Current rating:3Amps/Contact max

Contact resistance:max 10mΩ

Dielectric strength:min 1000VRMS

Operating temperature:-55°Cto+105°C

Soldering temperature:+245°C±5°C, 5s max

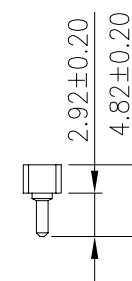
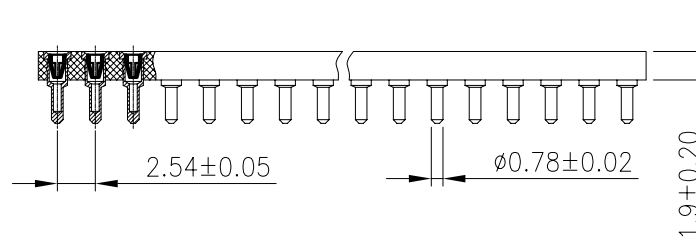
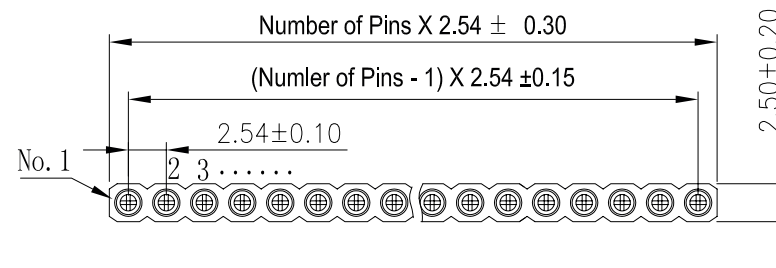

General description of ordering code

| FAMILY | TYPE | N° PIN | VERSION | CLIP PLATING | PACKAGE | SPECIAL |
|--------|-----------------|------------------|---------|----------------|----------------------|------------------|
| ZH | 0 [single line] | XX [1 ≤ XX ≤ 40] | D | F [flash gold] | T [tube] V [tray] | 19 [low profile] |



euro-conn



UNITS: mm

SHEET SIZE: ISO A4

SCALE:---

> 0 ~ 3

> 3 ~ 18

> 18 ~ 50

> 50 ~ 120

± 0.12

± 0.15

± 0.3

± 0.5



First angle projection

IC-SOCKET