

Electrical Specification:
 Rated Voltage: 250V AC/DC
 Rated Current: 3A
 Contact Resistance: 10mΩ Max.
 Insulation Resistance: 1000MΩ Max.
 Withstand voltage: 1000V AC/Min
 Temperature range for usage: -25°C~+85°C

Material:
 Contacts: Phosphor Bronze or Brass
 Finish: Tin plated
 Wire range : AWG#26~#22

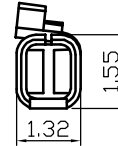
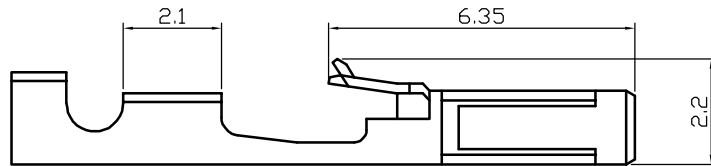
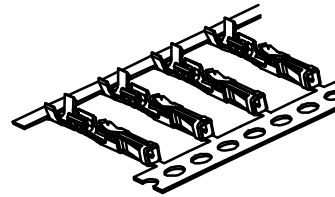
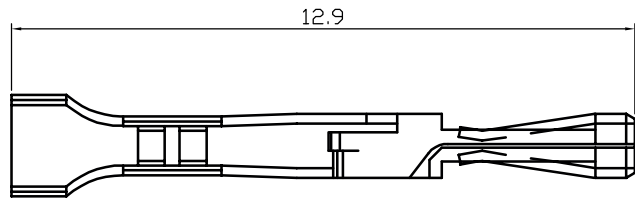

General description of ordering code

FAMILY	VERSION	CLIP PLATING	AWG
GM254	F [female]	F [flash gold]	1 [AWG 26-22]
		T [tin]	



euro-conn



UNITS: mm		SHEET SIZE: ISO A4		SCALE: ---	
> 0 ~ 3	> 3 ~ 18	> 18 ~ 50	> 50 ~ 120		
± 0.12	± 0.15	± 0.3	± 0.5		

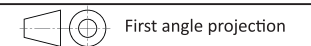

INTERCO254