

Electrical Specification:
 Rated Voltage: 250V AV.DC
 Rated Current: 3A
 Contact Resistance: 20mΩ Max.
 Insulation Resistance: 1000MΩ Min.
 Withstand voltage: 1500V AC/Min
 Temperature range for usage: -25°C~+85°C

Material:
 Housing: PA9T UL94V-0
 Contacts: Brass/Gold-flash

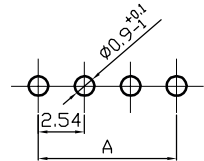

P. C. B LAYOUT

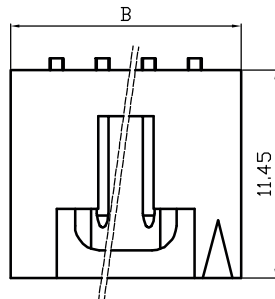
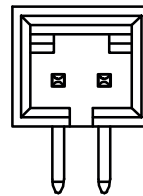
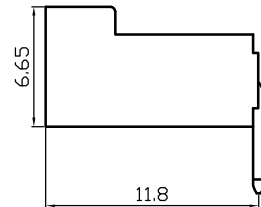
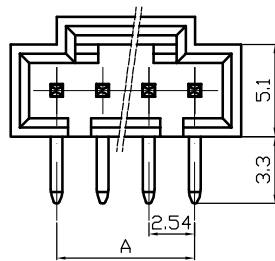

2P

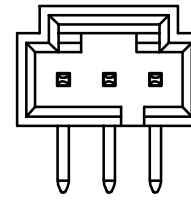

3P

Poles	Dimensions mm	
	A	B
2	2.54	7.56
3	5.08	10.10
4	7.62	12.64
5	10.16	15.18
6	12.70	17.72
7	15.24	20.26
8	17.78	22.80
9	20.32	25.34
10	22.86	27.88
11	25.40	30.42
12	27.94	32.96
--	--	--
24	48.26	63.44

General description of ordering code

FAMILY	ROWS	N° POLES	VERSION	CLIP PLATING	PEG
GM254	1	XX	R [right angle]	F [flash gold]	W [with peg]
				T [tin]	O [without]



euro-conn



UNITS: mm

SHEET SIZE: ISO A4

SCALE: ---

> 0 ~ 3

> 3 ~ 18

> 18 ~ 50

> 50 ~ 120

± 0.12

± 0.15

± 0.3

± 0.5

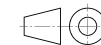

First angle projection

INTERCO254