

P. C. B LAYOUT

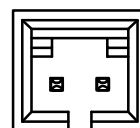

2P

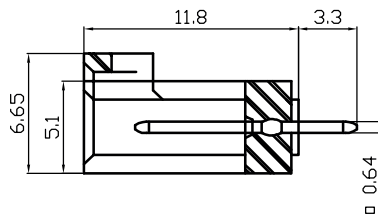
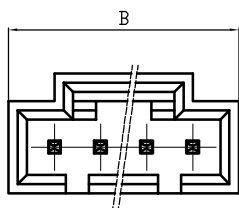
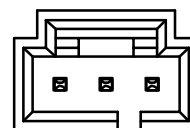

3P

Electrical Specification:

Rated Voltage:250V AV.DC
 Rated Current:3A
 Contact Resistance:20mΩ Max.
 Insulation Resistance:1000MΩ Min.
 Withstand voltage:1500V AC/Min
 Temperature range for usage: -25°C~+85°C

Material:

Housing:Nylon 66 UL 94V-0 +GF15%
 rass/Gold-flash

Poles	Dimensions mm	
	A	B
2	2.54	7.56
3	5.08	10.10
4	7.62	12.64
5	10.16	15.18
6	12.70	17.72
7	15.24	20.26
8	17.78	22.80
9	20.32	25.34
10	22.86	27.88
11	25.40	30.42
12	27.94	32.96
--	--	--
24	48.26	63.44

General description of ordering code

FAMILY	ROWS	N° POLES	VERSION	CLIP PLATING
GM254	1	XX	D [straight]	F [flash gold]
				T [tin]



euro-conn



UNITS: mm

SHEET SIZE: ISO A4

SCALE: ---

> 0 ~ 3

> 3 ~ 18

> 18 ~ 50

> 50 ~ 120

± 0.12

± 0.15

± 0.3

± 0.5



First angle projection

INTERCO254